

### *Advanced IP Phone with 3 lines & HD voice*

- TI TITAN chipset and TI voice engine
- 3 VoIP accounts, 132x64 graphic LCD
- HD Voice: HD Codec, HD speaker, HD handset
- Dual LAN, Headset and Expansion Module support



Yealink SIP-T26 is an advanced IP phone designed for maximum productivity and efficiency in the everyday business environment. It is equipped with the leading TI TITAN chipset, offers high definition voice quality through TI voice engine, HD handset, HD speaker and HD codec (G.722). Built-in 10 programmable DSSkeys support IP-PBX features like BLF/BLA, Intercom call pickup, etc. Six navigation keys and four soft keys help you use the phone easily. Ten dedicated function keys provide you with direct access to the functions for audio and call control. Moreover, SIP-T26 has the rich external interfaces including 2xLAN, PoE, headset and expansion module ports.

# Enterprise HD IP Phone

## SIP-T26

### Phone Features

3 VoIP accounts, hotline, emergency call  
Call waiting, call transfer, call forward  
Hold, mute, flash, auto-answer, redial  
3-way conference, DND, speed dial  
XML Phonebook search/import/export  
Black list, call history (100 entries)  
Volume adjustment, ring tone selection  
Tone scheme, System log  
Multi-language (more than 20)  
Supports up to 6 expansion modules

### IP PBX System Integration

Dial plan, dial-now  
SMS, Voicemail, MWI  
BLF/BLA, intercom, paging  
Call park, call pickup  
Distinctive ringtone

### Codecs and Voice Features

Wideband codec: G.722  
Narrowband codec: G.711, G.723.1,  
G.726, G.729AB  
VAD, CNG, AEC, PLC, AJB, AGC  
Full-duplex speakerphone with AEC

### Network Features

SIP v1 (RFC2543), v2 (RFC3261)  
NAT Traversal: STUN mode  
DTMF: In-Band, RFC2833, SIP Info  
Proxy mode and peer-to-peer SIP link mode  
IP Assignment: Static/DHCP/PPPoE  
TFTP/DHCP/PPPoE client  
Telnet/HTTP/HTTPS server  
DNS client  
NAT/DHCP server

### Management

FTP/TFTP/HTTP/PnP auto-provision  
Configuration: browser/phone/auto-provision  
Direct IP call without SIP proxy  
Dial number via SIP server  
Dial URL via SIP server

### Security

HTTPS (server/client)  
SRTP (RFC3711)  
Transport Layer Security (TLS)  
VLAN (802.1 pq), QoS  
Digest authentication using MD5/MD5-sess  
Secure configuration file via AES encryption  
Phone lock for personal privacy protection  
Admin/user configuration mode

### Physical Features

TI TITAN Chipset  
132x64 graphic LCD  
45 keys including 13 programmable keys  
1xRJ9 (4P4C) handset port  
1xRJ9 (4P4C) headset port  
2xRJ45 10/100M Ethernet ports  
1XRJ12 (6P6C) expansion module port  
Power adapter: AC 100~240V input  
and DC 5V/1.2A output  
(plugpack included with phone)  
(Power consumption: 1.6~2.6W)  
Net weight: 1.05KG  
Dimension: 273x204x42MM  
Operating humidity: 10~95%  
Storage temperature: up to 60°C

### Package Features

Qty/CTN: 5 PCS  
N.W/CTN: 7.87KG  
G.W/CTN: 9.00KG  
Measurement: 0.073CMB  
Carton Meas: 470x287x222MM

### Certifications

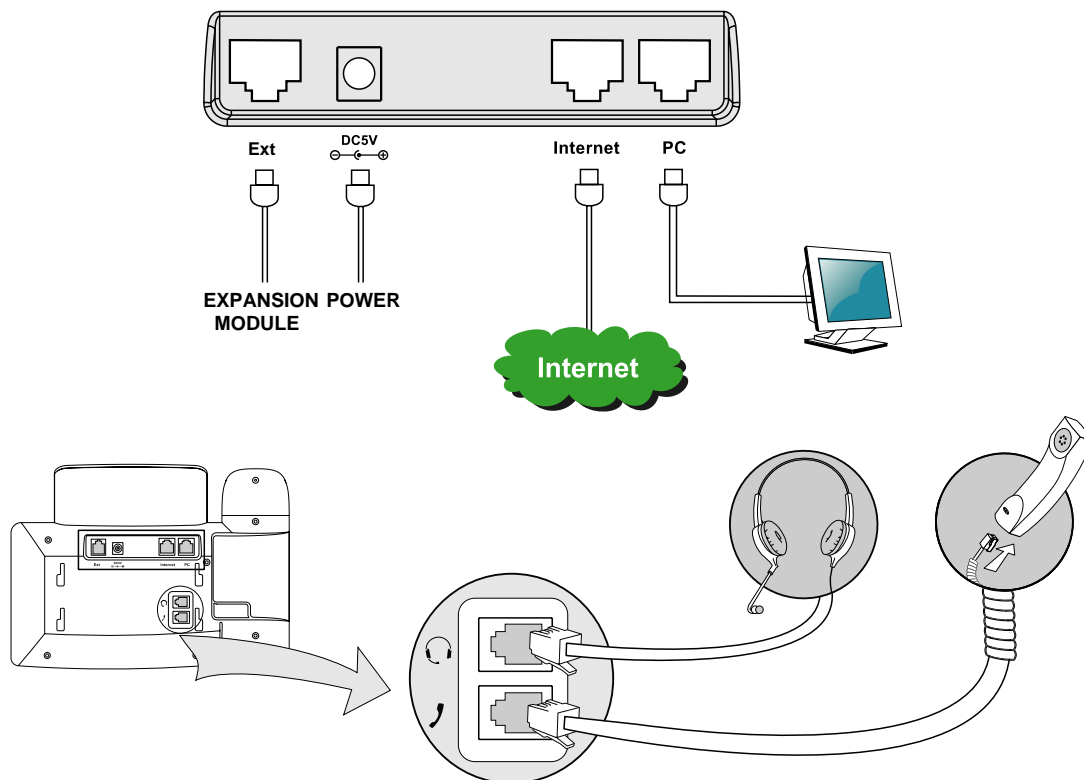

**Australia & New Zealand**

Tel: +61 3 8562 9000 FreeCall: 1800 817 807  
Email: sales@alloy.com.au Web: www.alloy.com.au

**AlloyCP - U.S.A.**

Tel: +1 703 6510 371 Tollfree: 888 895 8256  
Email: sales@alloycp.com Web: www.alloycp.com